

SWH30L50T<sub>xx</sub>-42-10BR

版本 (Versions)	修改内容 (Description)	标记 (REV)	日期 (Date)

感应器接线图  
or wiring diagram

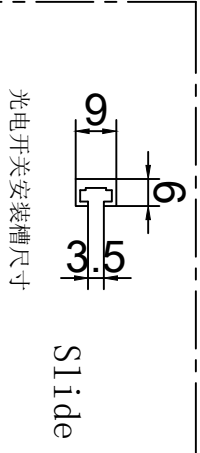
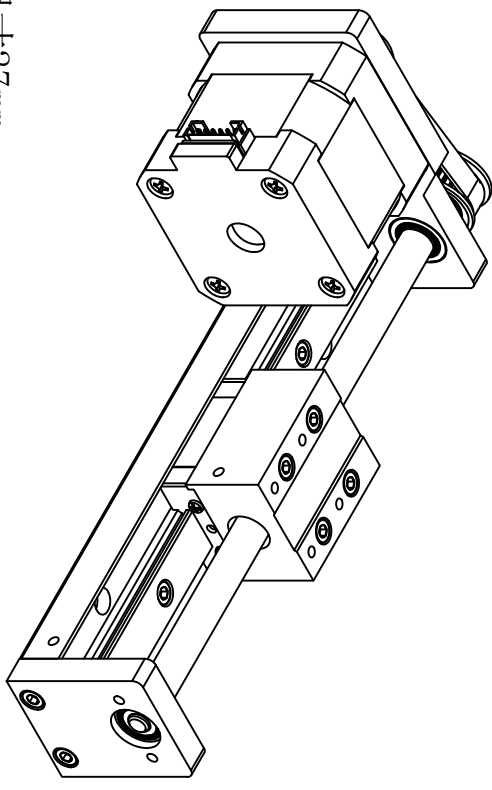
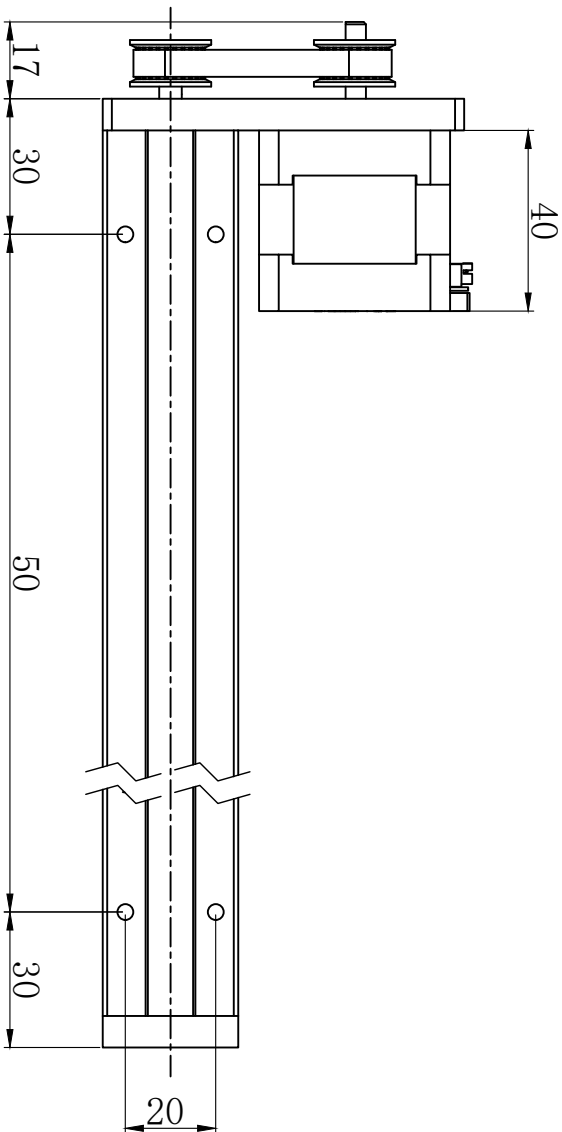
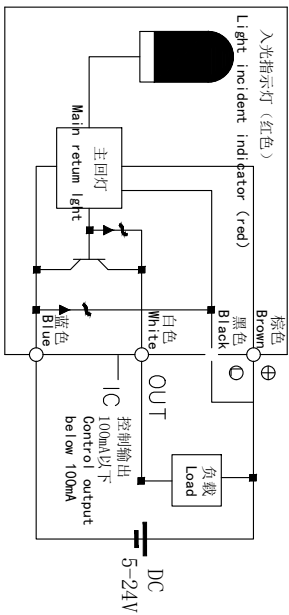

### 溜台机械限位尺寸28mm

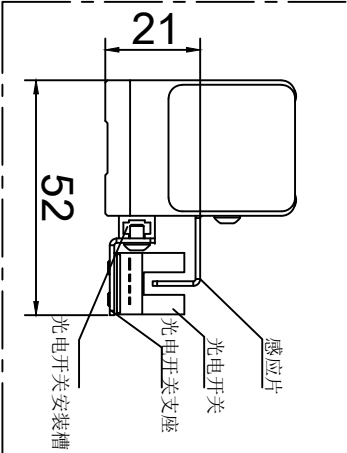

# 光电开关选配件

特性 character	规格 specifications
1. 导程 The guide	2/4/8
2. 步距角 Step Angle	1.8°
3. 保持转矩 Holding Torque	≥380 mN·M
4. 搭配马达 Pair with a motor	步进42
5. 加速度 acceleration	100ms (0.2s)
6. 重复定位精度 positioning accuracy	±0.05mm
8. 额定电流 Rated current	DC 1.68A
9. 传感器（选配） sensor	(NPN)+1米线
10. 重量 weight	-- kg

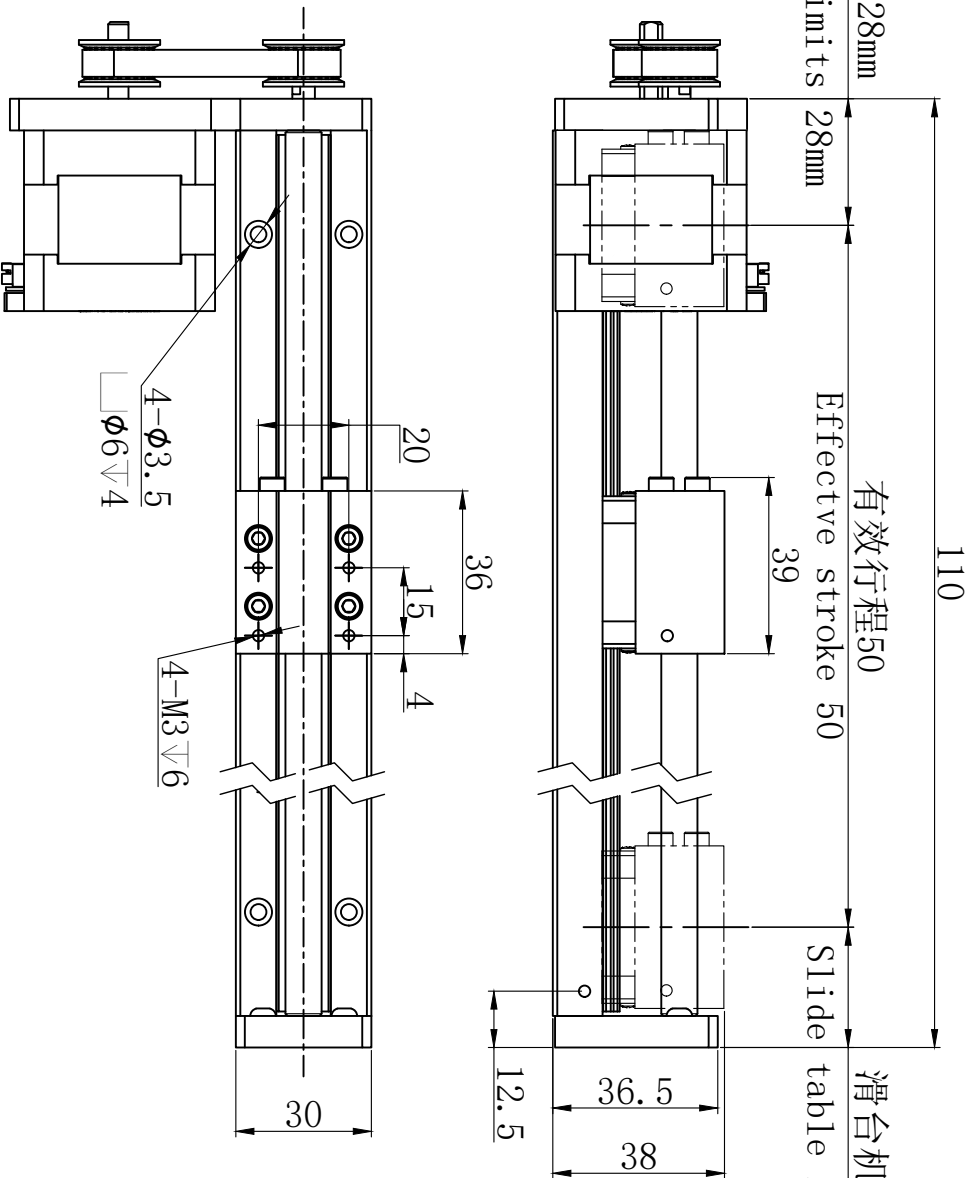

滑台机械限位尺寸27mm

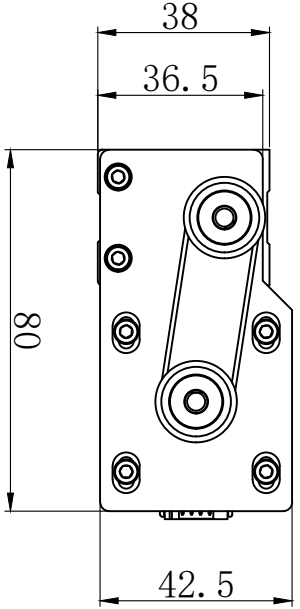

电气原理图  
winding drawing

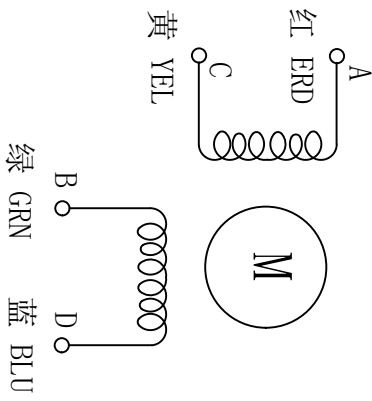
[illegible]