

符合RoHS指令要求
CONFORM TO RoHS DNSTRUCTIONS

A

A

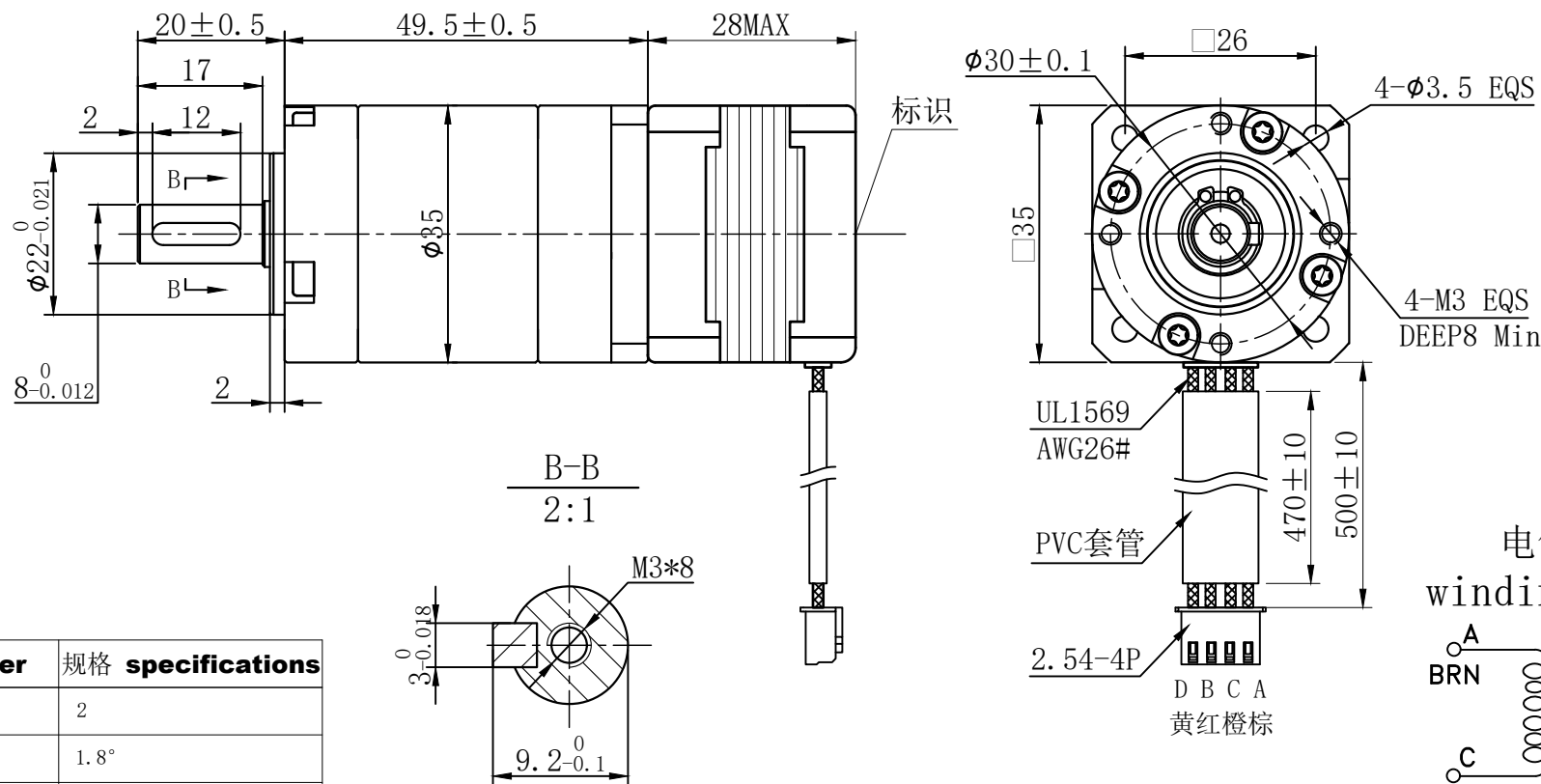

B

B

| 特性 character | 规格 specifications |
|---------------------------------------|--------------------------|
| 1. 相数 Number of phase | 2 |
| 2. 步 距 角 Step Angle | 1.8° |
| 3. 额定电压 Rated Voltage | DC 4.5V |
| 4. 额定电流 Rated current | DC 1.0A |
| 5. 保持转矩 Holding Torque | ≥ 200mN.m |
| 6. 相电阻 Winding resistance | 4.5±15% ohm(20℃) |
| 7. 相电感 Winding inductaoce | 5.5±20% mH (1kHz) |
| 8. 转向 (轴伸向看) Direction of rotation | A-AB-B-CW |
| 9. 转动惯量 Rotor Inertia | 25 g.cm ² |
| 10. 电机重量 Weight | 0.15Kg |
| 11. 绝缘等级 Insulation class | B Class |

Technical drawing of a mechanical part, labeled "B-B" and "2:1". The drawing shows a cross-section of a cylindrical component with a central hole. The outer diameter is 9.2 with a tolerance of $+0/-0.1$. The inner hole has a diameter of 3 with a tolerance of $+0/-0.018$. A thread of M3*8 is indicated on the right side.

減速比: 35:1

C

C

D

D

UMot

视图
view

比例
inverse
proportion

重庆优摩特科技有限公司
Chongqing UMot technology Co.Ltd.

阳祥

李佳兴

2023
05 10

AO

设计

审核

批准

日期

| | |
|----|--|
| 版本 | |
|----|--|

| | |
|----|--|
| 型号 | |
|----|--|

35HSH2408-35PG35.JM-500

1

2

3

4

5

E