

1	2	3	4	5	6
符合RoHS指令要求 CONFORM TO RoHS DNSTROCTIONS					

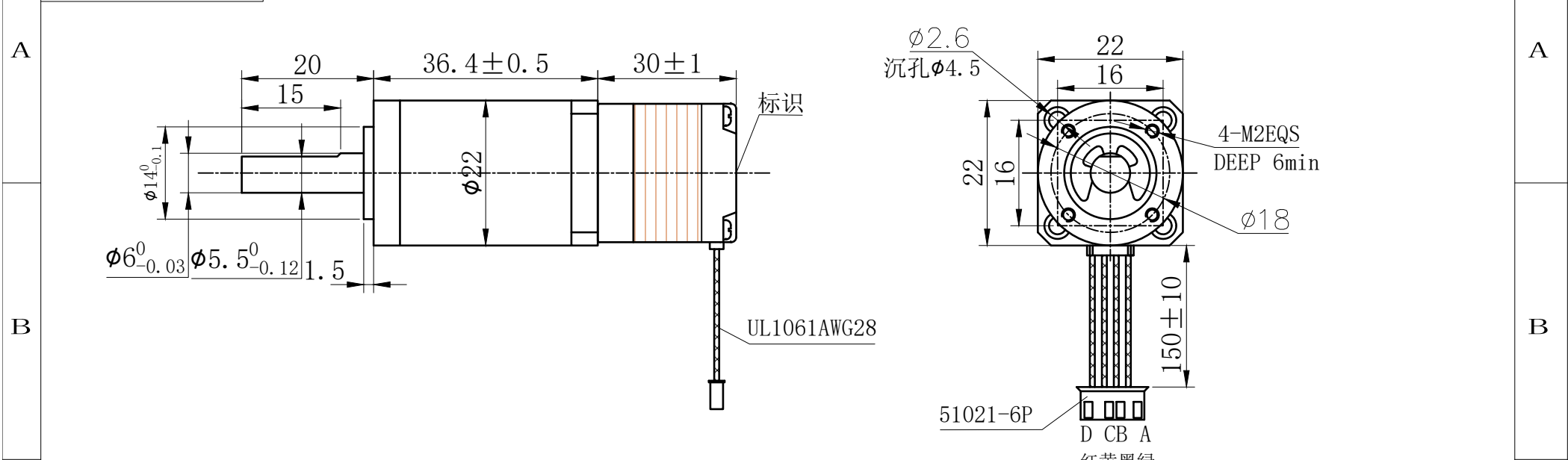

C			<div> <div>红黄黑绿</div> <div>电气原理图</div> <div>winding drawing</div>  </div>	C		
	特性 character	规格 specifications				
	1. 相数 Number of phase	2				
	2. 步 距 角 Step Angle	1.8°				
	3. 额定电压 Rated Voltage	DC 3.25V				
	4. 额定电流 Rated current	DC 0.5A				
	5. 保持转矩 Holding Torque	≥ 15mN.m				
	6. 相电阻 Winding resistance	6.5±15% ohm(20℃)				

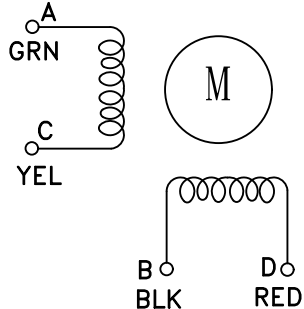