

1	2	3	4	5	6
符合RoHS指令要求 CONFORM TO RoHS DNSTROCTIONS					

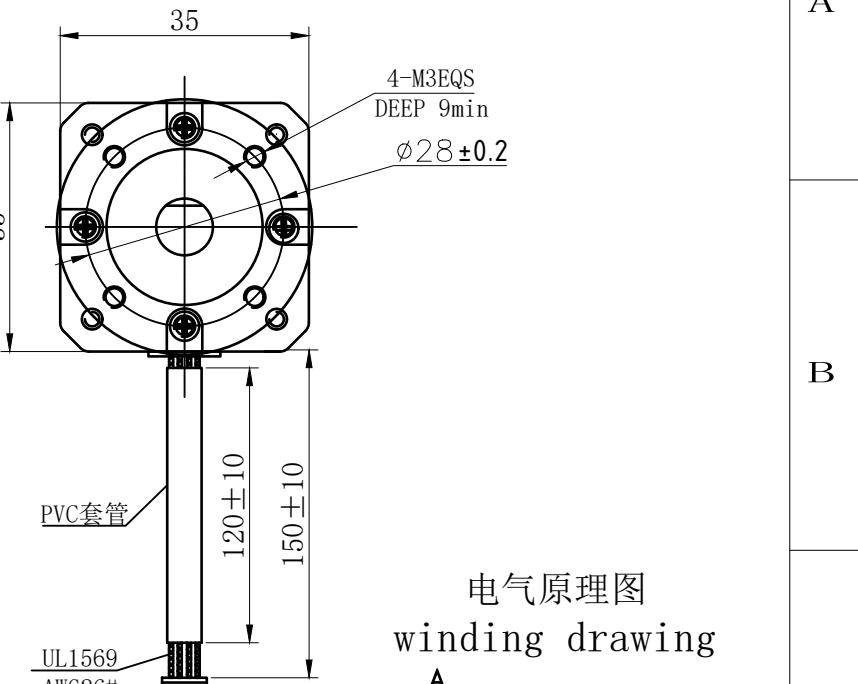
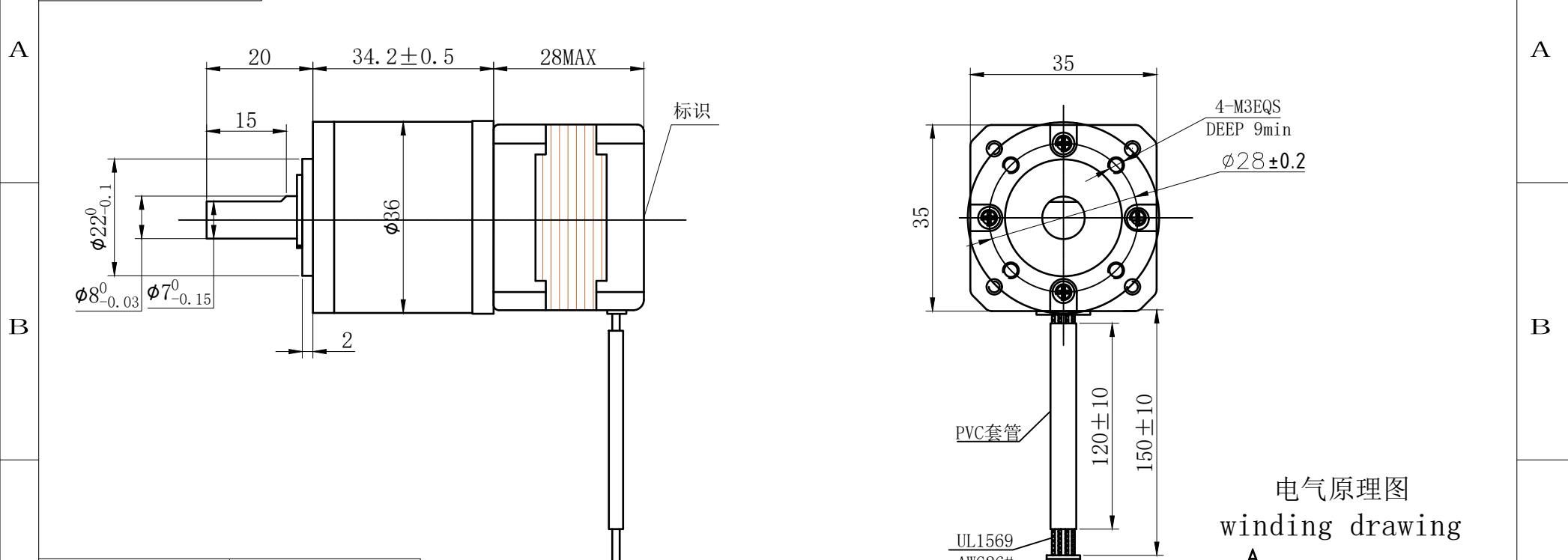

电气原理图
winding drawing

A schematic diagram of a motor winding. It features two separate windings. The first winding is on the left, with terminal 'A' (BRN) at the top and terminal 'C' (ORG) at the bottom. The second winding is on the right, with terminal 'B' (RED) on the left and terminal 'D' (YEL) on the right. A circle labeled 'M' is positioned between the two windings. The text '电气原理图' and 'winding drawing' is at the top. A large 'C' is on the right side of the diagram.

減速比: 1/19

C

D

特性character

规格specifications

1. 相数
Number of phase

2. 步距角
Step Angle

3. 额定电压
Rated Voltage

4. 额定电流
Rated current

5. 保持转矩
Holding Torque

6. 相电阻
Winding resistance

7. 相电感
Winding inductaoce

8. 转向（轴伸向看）
Directlon of rotation

9. 转动惯量
Rotor Inertia

10. 电机重量
Weight

11. 绝缘等级
Insulation class

2

1.8°

DC 4.5V

DC 1.0A

≥ 200mN.m

4.5±15% ohm(20℃)

5.5±20% mH（1kHz）

A-AB-B-CW

25 g.cm²

0.15Kg

B Class

REV

Description

Date

设计INSPECTED

审核CHECKED

批准APPROVED

日期Date

版本Version

型号Model

35HSH2408-36PG19J-150

1

2

3

4

5

6

AWG26#

母座

黄红橙棕

DBCA

BRN

C

ORG

M

B RED

D YEL

减速比：1/19

视图view

比例inverse proportion

1:1

A0

重庆优摩特科技有限公司
Chongqing UMot technology Co.Ltd.